

# DIN 6912

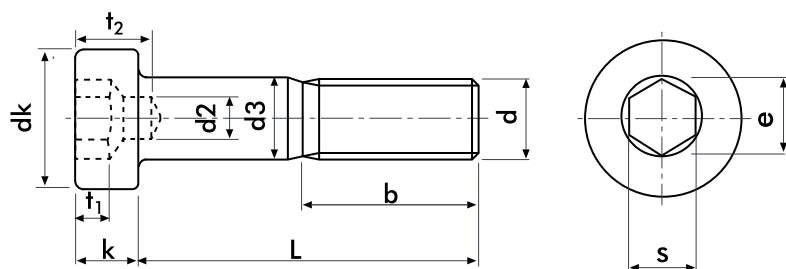

Aço 6.8; 8.8; 10.9; 12.9; Inox A2; A4;  
Steel 6.8; 8.8; 10.9; 12.9; Stainless Steel A2; A4;  
Acero 6.8; 8.8; 10.9; 12.9; Acero Inoxidable A2; A4;  
Acier 6.8; 8.8; 10.9; 12.9; Acier Inoxydable A2; A4;  
Acciaio 6.8; 8.8; 10.9; 12.9; Acciaio Inossidabile A2; A4;

## Parafuso cabeça cilíndrica com sextavado interior e c/ centrador

Hexagon socket low head cap screws with pilot recess | Tornillo de cabeza cilíndrica baja con hueco hexagonal con centrador | Vis à tête cylindrique réduite à 6 pans creux avec guidage | Viti testa cilindrica cava esagonale

D	M4	M5	M6	M8	M10	M12	M14	M16	M18	M20	M22	M24	M27	M30	M33	M36
P (1)	0.7	0.8	1	1.25	1.5	1.75	2	2	2.5	2.5	2.5	3	3	3.5	3.5	4
b (l < 125)	14	16	18	22	26	30	34	38	42	42	46	54	60	66	72	78
b (125 < l < 200)	-	-	-	-	32	36	40	44	48	48	52	60	66	72	78	84
b (l > 200)	-	-	-	-	-	-	-	57	61	61	65	73	79	85	91	97
dk max.	7	8.5	10	13	16	18	21	24	27	27	30	36	40	45	50	54
dh min.	2	2.5	3	4	5	6	7	8	8	8	10	12	12	15	16.5	18
ds max.	4	5	6	8	10	12	14	16	18	18	20	24	27	30	33	36
e	3.44	4.58	5.72	6.86	9.15	11.43	13.72	16	16	16	19.44	21.73	21.73	25.15	27.43	30.85
k max.	2.8	3.5	4	5	6.5	7.5	8.5	10	11	11	12	14	16	17.5	19.5	21.5
s	3	4	5	6	8	10	12	14	14	14	17	19	19	22	24	27
t1	1.6	2	2.5	3	3.5	4	4.5	5.5	6	6	6.5	7	8.5	9	10	11.5
t2 min.	3.3	4	5	6.5	7.5	9	10	11.5	12.5	12.5	14	16	17	19	20	24
t2 max.	3.6	4.3	5.3	6.86	7.86	9.36	10.36	11.93	12.93	12.93	14.43	16.43	17.43	19.52	20.52	24.52
L (mm)	peso/ weight/ peso/ poids/ peso - 1000pc/Kg															
10	1.3	2.2	3.6													
12	1.5	2.5	3.9	7.7												
16	1.9	3.1	4.5	8.8	15.5	22.3										
18	2.3	3.7	5.2	10.2	17.9	25.5	37.9	52.5								
20	2.7	4.4	6.2	12.5	20.2	29.5	42.5	56.5								
25	3.2	5.1	7.3	14.0	22.0	32.5	48.0	63.0	77.0							
30	3.4	5.8	8.3	15.7	25.5	36.5	53.0	69.7	84.6	108						
35	4.2	6.6	9.5	17.5	28.5	40.0	58.0	78.7	102	118						
40	5.2	7.3	11.5	21.5	34.8	48.0	69.5	91.5	119	128	185					
50		9.0	13.6	25.3	40.3	57.0	82.0	107	138	150	215					
60			15.7	29.1	46.0	65.0	92.5	122	157	172	245	263				
70				32.8	52.5	72.0	104	140	178	196	275	298	445	498		
80					57.8	80.0	116	154	196	222	305	333	490	552	793	
90						88.0	127	169	215	245	335	369	535	607	860	1000
100							139	183	235	269	365	407	580	662	927	1080
110							151	198	255	292	395	439	625	717	994	1160
120								212	275	316	425	474	670	772	1060	1240
130								226	295	342	455	510	715	827	1130	1320
140									315	368	485	545	760	880	1190	1400
150										392	515	580	805	940	1250	1470
160										422	545	616	850	990	1320	1550
170										448	575	651	895	1050	1380	1630
180										474	605	687	940	1100	1450	1710
190											635	722	995	1160	1510	1790
200											665	758	1030	1210	1580	1870

Outras medidas sob consulta | Other measures upon request | Otras medidas solo bajo encargo | Autres mesures sur demande | Altre misure a richiesta  
P (1) passo de rosca | thread pitch | paso de rosca | pas filetage | passo del filetto

Vários acabamentos. Peça-nos mais informações. | Surface treatment. Please ask us for more information. | Acabamientos variados. Pídenos más información. | Plusieurs finitions. Contactez-nous pour plus d'informations. | Ricopertura di superficie. A richiesta.

1 5 10 15 20 25 50 100 150 200 250 400 500 1000  
peças, pieces, piezas, pièces, pezzi